

PHASE - I BUILDING - A1

TYPICAL 8TH & 12TH FLOOR PLAN

RERA REGISTRATION NO. P5210000562

1, 1.5, 2 & 3 BHK GREEN HOMES

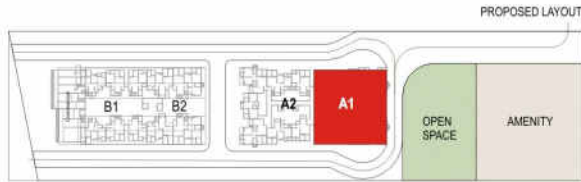

ILLUSTRATIVE PRESENTATION APARTMENT PLAN



LAYOUT AS PER SANCTION

Flat No.	Flat Type	**Carpet Area		Exclusive Enclosed Balc.		Dry Balc.		Terrace		*Total Usable Area	
		sq.mt	sq.ft	sq.mt	sq.ft	sq.mt	sq.ft	sq.mt	sq.ft	sq.mt	sq.ft
#801,1201	1 BHK	30.2	325	4.12	44	2.16	23	6.18	67	42.6	459
#803,1203	2 BHK	47.0	506	6.39	69	2.31	25	8.14	88	63.8	687
#804,1204	2BHK	44.5	478	6.46	70	2.29	25	8.91	96	62.1	669
#805,1205	3 BHK	63.2	681	9.27	100	2.41	26	8.96	96	83.9	903
#806,1206	3 BHK	61.1	658	9.24	99	2.41	26	8.96	96	81.7	880

Note: 1. **Carpet Area is calculated according to RERA norms, Excluding Plaster thickness & Including Cupboard Area. 2. Plaster Thickness are considered as Internal Plaster 10mm & External Plaster 20mm
 3. All the areas other than carpet area are mentioned for illustration purpose only. 4. Sale of apartment is on carpet area only. 5.*Gross usable area = FLAT CARPET AREA + ENCLOSED BALCONY + TERRACE AREA + DRY TERRACE.
 6. All Dimensions mentioned are for Unfinished surface & Including Enclosed Balcony.

PHASE - I BUILDING - A1

TYPICAL 2ND, 4TH, 6TH, 10TH & 12TH FLOOR PLAN

RERA REGISTRATION NO. P52100000562

1, 1.5, 2 & 3 BHK GREEN HOMES

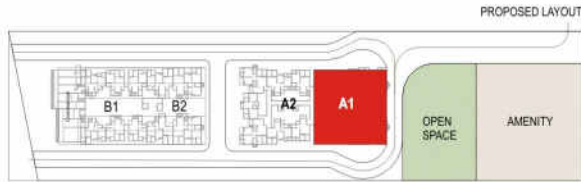

ILLUSTRATIVE PRESENTATION APARTMENT PLAN



LAYOUT AS PER SANCTION

Flat No.	Flat Type	**Carpet Area		Exclusive Enclosed Balc.		Dry Balc.		Terrace		*Total Usable Area	
		sq.mt	sq.ft	sq.mt	sq.ft	sq.mt	sq.ft	sq.mt	sq.ft	sq.mt	sq.ft
#201,401,601,1001	1 BHK	30.2	325	4.12	44	2.16	23	6.18	67	42.6	459
#202,402,602,1002	1 BHK	32.2	346	4.00	43	2.16	23	6.02	65	44.4	477
#203,403,603,1003	2 BHK	47.0	506	6.39	69	2.31	25	8.14	88	63.8	687
#204,404,604,1004	2BHK	44.5	478	6.46	70	2.29	25	8.91	96	62.1	669
#205,405,605,1005	3 BHK	63.2	681	9.27	100	2.41	26	8.96	96	83.9	903
#206,406,606,1006	3 BHK	61.1	658	9.24	99	2.41	26	8.96	96	81.7	880

Note: 1. ** Carpet Area is calculated according to RERA norms, Excluding Plaster thickness & Including Cupboard Area. 2. Plaster Thickness are considered as Internal Plaster 10mm & External Plaster 20mm
 3. All the areas other than carpet area are mentioned for illustration purpose only. 4. Sale of apartment is on carpet area only. 5. *Gross usable area = FLAT CARPET AREA + ENCLOSED BALCONY + TERRACE AREA + DRY TERRACE
 6. All Dimensions mentioned are for Unfinished surface & Including Enclosed Balcony.

PHASE - I BUILDING - A1

TYPICAL 1ST, 3RD, 5TH, 7TH, 9TH & 13TH FLOOR PLAN

RERA REGISTRATION NO. P52100000562



1, 1.5, 2 & 3 BHK GREEN HOMES

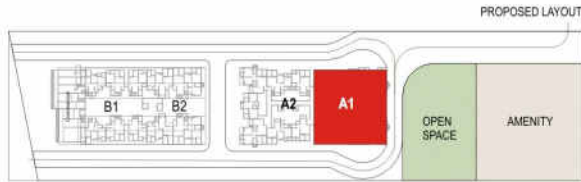

ILLUSTRATIVE PRESENTATION APARTMENT PLAN



LAYOUT AS PER SANCTION

Flat No.	Flat Type	**Carpet Area		Exclusive Enclosed Balc.		Dry Balc.		Terrace		*Total Usable Area	
		sq.mt	sq.ft	sq.mt	sq.ft	sq.mt	sq.ft	sq.mt	sq.ft	sq.mt	sq.ft
#101,301,501,701,901,1101,1301	1 BHK	29.8	320	4.04	43	2.16	23	6.24	67	42.2	454
#102,302,502,702,902,1102,1302	1 BHK	31.6	340	3.95	43	2.16	23	6.08	65	43.8	471
#103,303,503,703,903,1103,1303	2 BHK	47.1	507	6.2	67	2.31	25	8.13	88	63.8	686
#104,304,504,704,904,1104,1304	2BHK	44.9	484	6.6	71	2.29	25	8.86	95	62.7	675
#105,305,505,705,905,1105,1305	3 BHK	63.0	678	9.1	98	2.41	26	8.95	96	83.4	898
#106,306,506,706,906,1106,1306	3 BHK	60.6	653	9.3	100	2.41	26	8.96	96	81.3	875

Note: 1. ** Carpet Area is calculated according to RERA norms, Excluding Plaster thickness & Including Cupboard Area. 2. Plaster Thickness are considered as Internal Plaster 10mm & External Plaster 20mm
3. All the areas other than carpet area are mentioned for illustration purpose only. 4. Sale of apartment is on carpet area only. 5.*Gross usable area = FLAT CARPET AREA + ENCLOSED BALCONY + TERRACE AREA + DRY TERRACE
6. All Dimensions mentioned are for Unfinished surface & Including Enclosed Balcony.